



PRODUCTS FOR OUR ENVIRONMENT

## TECHNICAL DATA SHEET

### ERS-408 Tri. Laminate Base

P/N: 045-0015

For Professional Use Only

#### PRODUCT DESCRIPTION:

ERS-408 Tri. Laminate Base is a high performance, asphalt coated triple reinforced polyester/glass/polyester base sheet that utilizes a roofing-dedicated asphalt coating. This coating enhances system adhesion and increases total waterproofing weight of the final membrane. ERS-408 Tri. Laminate Base is a continuously applied product that does not require cutting into short lengths and relaxing before installation.

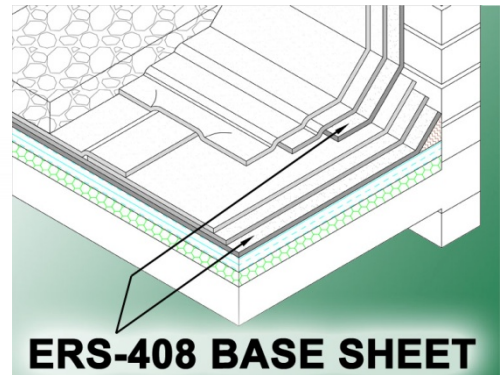

**ERS-408 BASE SHEET**

#### RECOMMENDED USES:

ERS-408 Tri. Laminate Base can be used as a base ply under any of Ecology's modified cap membranes. When used as a base or interply in one of Ecology's cold-applied or hot-applied built-up systems, tremendous system strengths can be achieved, far exceeding NBS-55 criteria. As a base ply under an Ecology Flashing Membrane, ERS-408 Tri. Laminate Base adds greater strength to this critical area of the roof assembly.

#### ADVANTAGES:

- Can be applied using conventional equipment.
- Compatible with hot and cold asphalt adhesives.
- Does not require cutting into short lengths before placement into cold adhesive, allowing for a more efficient and speedier application.
- Provides very high tensile – assuring high performance.
- Exceeds requirements of ASTM D 4601.
- Utilizes a roofing-dedicated asphalt to ensure premium roof system performance and durability.
- Classified by Underwriters, Inc.® as to an external fire exposure only.

#### APPROVALS:



#### INSTALLATION:

**Nailed Base Sheet:** Remove wrinkles and slack from base sheet prior to nailing. This is best accomplished by a shuffling motion of the feet of the mechanic installing the membrane working just ahead of the person nailing the base sheet to the deck.

Follow nailing specifications without modification. Fasteners must be as recommended by the deck manufacturer. All nailing shall be done through flat metal caps, no less than 1" in diameter. Fastening pattern for mechanically fastened base sheet must be in accordance with approval requirements of the applicable testing entities.

**Cold Applied Built-Up Roof:** Run starter strips (headers) parallel to parapet walls and perimeter details. These should be installed by hand prior to the reinforcing plies. End laps must be staggered 4' minimum. Embed each ply in a uniform continuous application of adhesive immediately. Broom each ply to ensure adhesion.

Point loading during the time of application may force the interply adhesive from between the reinforcing plies. Every effort should be made to allow the waterproofing bitumen to set before being exposed to either foot or wheeled traffic.

Position and unroll ply sheet from insulation or deck side of roll. Do not kick out from behind roll. Also, keep equipment off the finished roof surface. Realignment of product after unrolling will cause wrinkling and fishmouths. Four (4) inch end laps should be staggered 4' minimum. When end laps are necessarily in line, cover with a full width of ERS-408 Tri. Laminate Base. Overlap previous day's work by 12".

**PACKAGING:**

2 square rolls - 3' x 72'; 30 rolls per pallet.

**STORAGE LIFE:**

One (1) year from date of shipment when stored in a cool, dry place, preferably indoors.

**PHYSICAL PROPERTIES:**

Test	Typical Value	Test Method
Weight (lbs/roll), min	70 lbs., min.	ASTM D 228
Thickness	60 mils	ASTM D 146
Breaking Strength	135 - 165 MD 130 - 155 XMD	ASTM D 146
Fire Resistance	Pass, Class A	UL 790
Pliability (1/2" radius)	No Failures	ASTM D 146
Asphalt (wt/roll – lbs.)	30	ASTM D 4601
Surfacing & Stabilizer	14 lbs/100ft <sup>2</sup>	ASTM D 4601
Trapezoid Tear Strength (lbf)	28 – 32 MD 15 – 20 XMD	ASTM D 5733
Moisture	0%	ASTM D 146
Puncture Resistance	110 – 130	ASTM E 154
Mass of polyester/glass/polyester mat (lbs/roll)	4.75	ASTM D 228

## *Ecology Roof Systems*®

Corporate Offices

9821 Olde Eight Road, Unit F, Northfield, OH 44067

PHONE: 330-467-4220 FAX: 330-467-4225

[www.ecologyroof.com](http://www.ecologyroof.com)

**REGIONAL OFFICES LOCATED ACROSS THE U.S.**

To the best of our knowledge, all technical data contained herein is true and accurate as of the date of issuance and subject to change without prior notice. User must contact Ecology Roof Systems to verify correctness before specifying or ordering. We guarantee our products to conform to the quality control standards established by Ecology Roof Systems. We assume no responsibility for coverage, performance or injuries resulting from use. Liability, if any is limited to replacement of the product. NO OTHER WARRANTY OR GUARANTEE OF ANY KIND IS MADE BY ECOLOGY ROOF SYSTEMS, EXPRESSED OR IMPLIED, STATUTORY, BY OPERATION OF LAW, OR OTHERWISE, INCLUDING MERCHANTABILITY AND FITNESS FOR A PARTICULAR PURPOSE.