

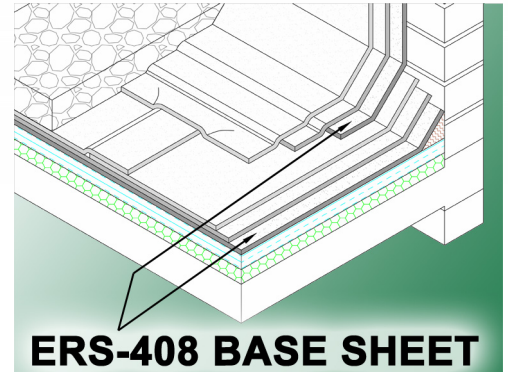

PRODUCTS FOR OUR ENVIRONMENT

PRODUCT DATA SHEET

ERS-408



ERS-408 BASE SHEET

TRI-DIRECTIONAL BASE SHEET

ERS-408 is one of the toughest conventional base sheets offered in today's roofing market. ERS-408 is designed with a unique, tri-dimensional reinforcement that has a glass-fiber scrim sandwiched between two tough outer layers of non-woven polyester. The addition of the polyester fabric offers added toughness and elongation characteristics not possible with traditional, glass-reinforced ply sheets. The tri-dimensional scrim is impregnated and coated with durable, weathering-grade asphalt and surfaced with a fine mineral material for easy application and excellent interply adhesion. Features also include outstanding breaking strength and tear resistance.

ERS-408 can be used as a base ply under any of Ecology's modified cap membranes. When used as a base or interply in one of Ecology's cold-applied or hot-applied built-up systems, tremendous mat strengths can be achieved, far exceeding NBS-55 criteria. As a base ply under an Ecology Flashing Membrane, ERS-408 adds greater strength to this critical area of the roof assembly.

APPLICATION STANDARDS

Whether incorporated as a component in one of Ecology's built-up or modified cap membrane roof specifications, ERS-408 can be installed with Ecology's ERS-All Temp Asphalt, ERS-Hot Flex Asphalt, one of Ecology's VOC approved cold process adhesives, or with approved mechanical fasteners. The roll has 2" and 4" guideline markings for ease of installation.

GENERAL DATA

Membrane Type	G-2
Roll Dimensions	3' x 72'
Top/Bottom Surface	Lightly Sanded
Weight	72 lbs. per roll
Roll Net Coverage	2 square
Rolls Per Pallet	30



Ecology Roof Systems®

Corporate Offices
1400 North Harbor Blvd. Suite #601, Fullerton, CA 92835
PHONE: 800 553-3833 FAX: 714 526-1034
www.ecologyroof.com

REGIONAL OFFICES LOCATED ACROSS THE U.S.