

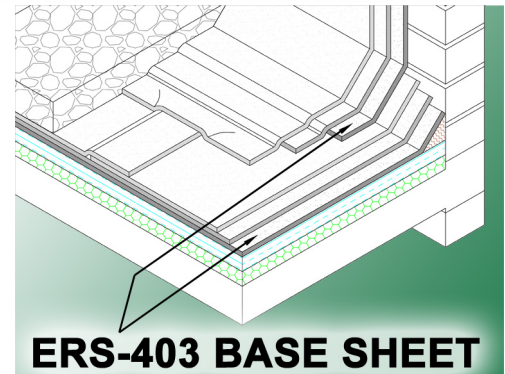

PRODUCTS FOR OUR ENVIRONMENT

PRODUCT DATA SHEET

ERS-403



ERS-403 BASE SHEET

POLY REINFORCED MODIFIED BASE SHEET

ERS-403 is designed to be used as the initial base ply within an Ecology roof system where high tensile strength and elongation properties are desired. It is constructed with a heavy-duty, polyester mat that is impregnated and coated with an SBS (Styrene Butadiene Styrene) modified asphalt and has lightly sanded surfaces. Features include outstanding breaking strength and tear resistance. Typical uses would include specifications over lightweight concrete deck systems calling for the base sheet to be mechanically attached, or adhered in hot or cold adhesive. ERS-403 meets the requirements of ASTM-D-5147.

ERS-403 can be installed with Ecology's ERS-All Temp, ERS-Hot Flex Modified Asphalt, or with approved mechanical fasteners. The membrane can also be installed with one of Ecology's low VOC cold process adhesives, ERS-302, or ERS-309. The membrane can be incorporated into several of Ecology's built-up and modified cap membrane roof specifications.

GENERAL DATA

Roll Dimensions	39.5" x 67'
Roll Net Coverage	2 square



Ecology Roof Systems®

Corporate Offices
1400 North Harbor Blvd. Suite #601, Fullerton, CA 92835
PHONE: 800 553-3833 FAX: 714 526-1034
www.ecologyroof.com

REGIONAL OFFICES LOCATED ACROSS THE U.S.